

# Installation Instructions



## Heat Exchanger Assembly

for use by heating contractor  
for Vitodens 200-W, WB2B 45, 60 / B2HA 45, 60

Part Number: 7826540 **Gasket Set**  
Part Number: 7835597 **Combustion Chamber Refractory**  
Part Number: 7826535 **Condensate Hose**  
Part Number: 7826545, 7826546, 7839725, 7833468 **Connection Pipe**

---

### Safety and Installation Requirements

Please ensure that these instructions are read and understood before starting any service work. Failure to comply with these instructions may cause product/property damage, severe personal injury and/or loss of life.

#### Working on the equipment

The installation, adjustment, service and maintenance of this product must be performed by a licensed professional heating contractor who is qualified and experienced in the installation, service, and maintenance of hot water boilers.

There are no user serviceable parts on the boiler, burner or control.

Ensure that main power to the equipment being serviced is off.

Ensure that the main fuel supply valve to the boiler is closed.

Take precautions to avoid accidental activation of power or fuel during service work.

Do not perform service work on any component part without ensuring safe operation of the heating system. When replacing parts, use original Viessmann or Viessmann approved replacement parts.



Refer to the Installation and Start-up/Service Instructions applicable to this boiler.

## Accessing the Heat Exchanger

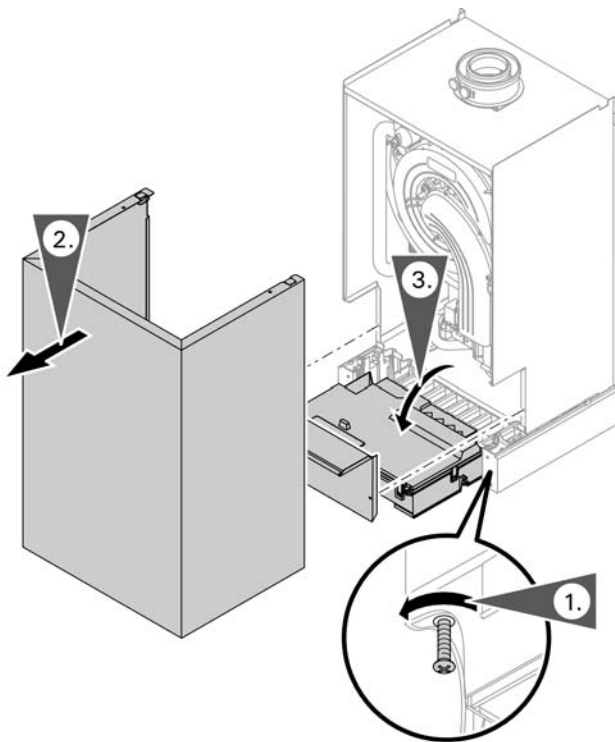

With the electrical power and fuel supply off, open the control cover and switch the ON/OFF boiler "ⓐ" control switch to OFF.

1. Loosen the screws at the bottom of the boiler as shown (do not remove completely).
2. Slide out and remove front enclosure panel.
3. Release the hinged hooks located on both sides of the control unit and then fold down the control unit.

## Removing the Burner

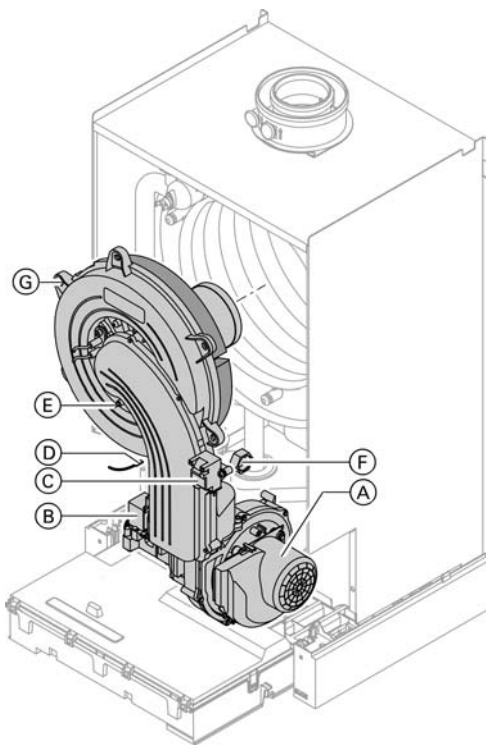

1. Disconnect all wiring connectors ⓐ, ⓑ, ⓒ, ⓓ and ⓔ.
2. Loosen the gas line nut ⓕ.
3. Remove the six screws ⓖ and remove the burner.

## Replacing Heat Exchanger

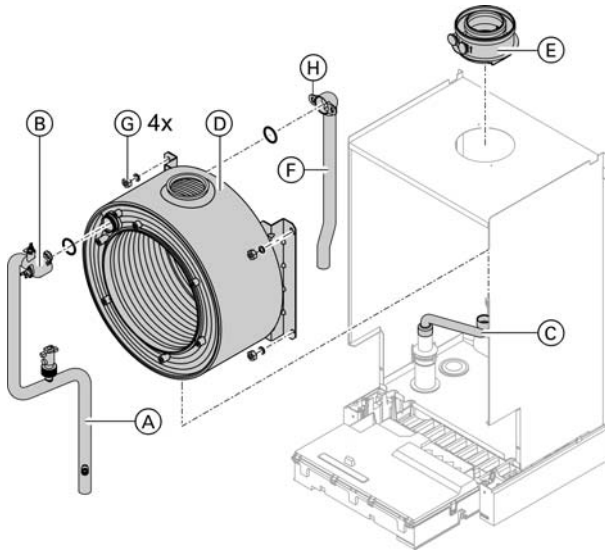

### Legend

Tighten the following fasteners on assembly:

- (B) 70.8 lb.in. (8 Nm)
- (E) 8.9 lb.in. (1 Nm)
- (G) 40 lb.in. (4.5 Nm)
- (H) 70.8 lb.in. (8 Nm)

1. Drain water from the heat exchanger through the sediment faucet drain valve.

### IMPORTANT

Residual water may leak out during disassembly.

2. Remove the wiring from the sensors on supply pipe (A).
3. Loosen the nuts on supply pipe (A) and connection elbow (B). Remove supply pipe (A) with sensors.

### IMPORTANT

The control console must be removed to protect it from accidental water spillage.

4. Loosen by hand and remove the condensate hose (C).
5. Disconnect the flue gas temperature sensor plug inside the boiler from the vent pipe adaptor (E).
6. Remove the four Allen screws (4 mm) and disconnect the vent pipe adaptor (E) from the heat exchanger.
7. Loosen compression fitting on the bottom of return pipe (F).
8. Remove the four 10 mm Hex nuts (G) and remove heat exchanger (D) from the boiler.
9. Remove the Torx screws (T-40) at the top of the heating return pipe (F) and remove with O-rings.

### IMPORTANT

Use new gaskets and O-rings on all connections.

10. Replace parts as required and reassemble the heat exchanger as per steps 9 through 2 respectively and torque fasteners per legend.

## Reconnecting the Boiler

Install the condensate drain pipe with a suitable gradient. Pull the condensate hose so far out of the boiler that no unnecessary bends are created inside the boiler. Check tightness of siphon connection.

### IMPORTANT

Ensure the condensate drain pipe is pulled down and positioned to allow the condensate to properly drain.

2. Discharge condensate from the boiler into the drainage system, either directly or (if required) via a neutralization unit (accessory).



Installation Instructions of Neutralization Unit (if applicable)

### IMPORTANT

Pipe ventilation must take place between the siphon trap and the neutralization unit (if applicable).

### IMPORTANT

Do not connect the drain pipe from any other appliance, such as water softener backwash pipe, to Vitodens condensate drain pipe.

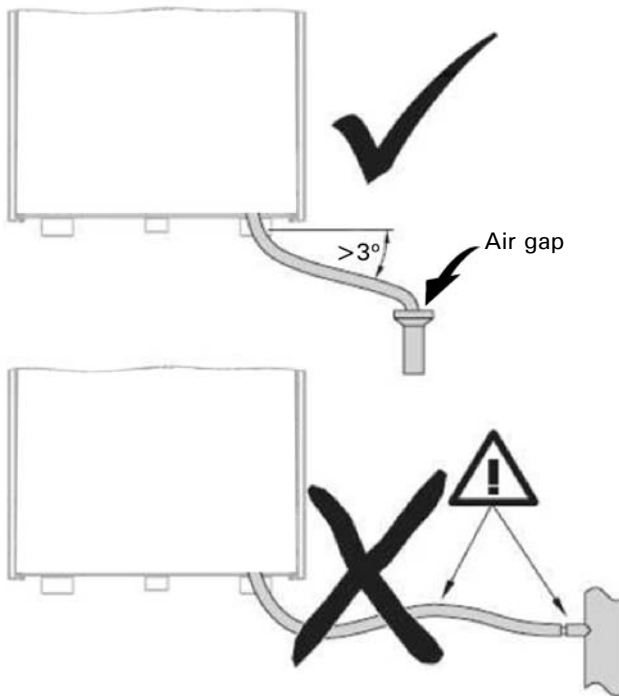

1. Fill the boiler, bleed air and check for leaks.



Refer to the Installation and Service Instructions to activate air bleed program.

2. Install burner assembly.



### WARNING

Gas leaks can lead to explosions. Check the gas pipe seals to ensure that there are no leaks.

3. Close control unit.
4. Install front enclosure.
5. Place the boiler back in operation.



For more details refer to the Installation and Service Instructions applicable to this boiler.

